

PLACE ARROW INDICATING NORTH DIRECTION RELATIVE TO CROSSING

FORM DR-0404-C
REV. 12-12-00
www.uprr.com

UNCASED GAS TRANSMISSION PIPELINE CROSSING

NO SCALE

NOTE: ALL AVAILABLE DIMENSIONS MUST BE FILLED IN TO PROCESS THIS APPLICATION.

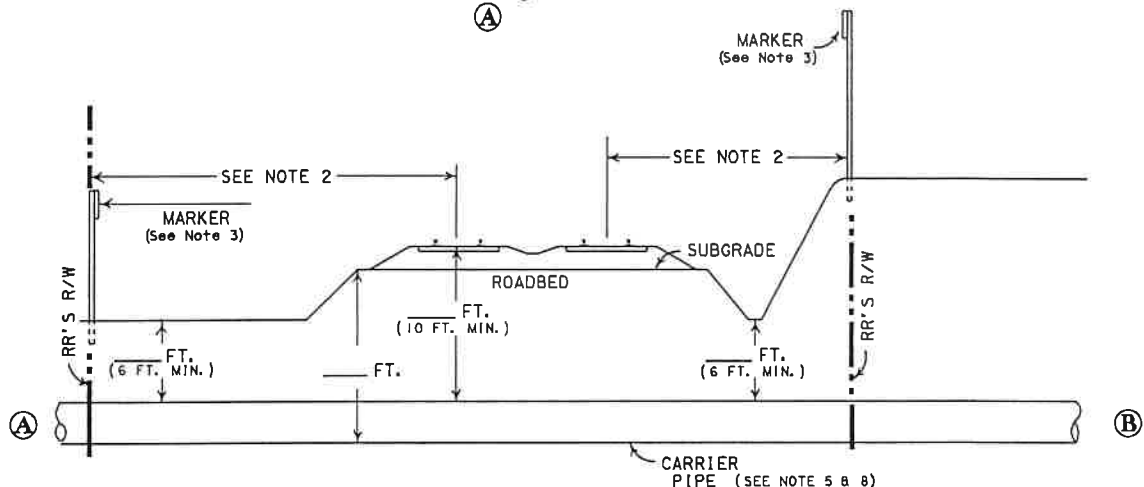
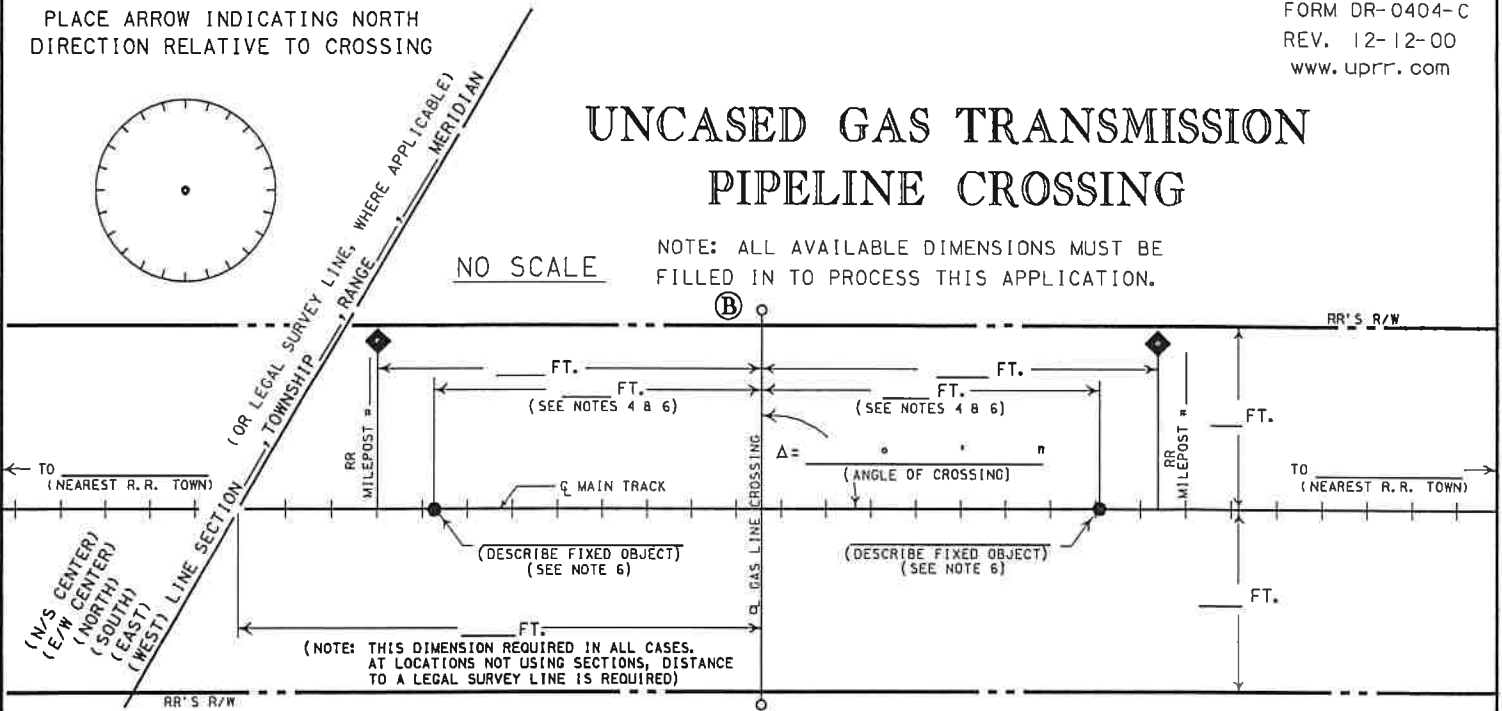

NOTES :

- 1) ALL HORIZONTAL DISTANCES TO BE MEASURED AT RIGHT ANGLES FROM ϵ OF TRACK.
- 2) REQUISITES FOR CARRIER LINE PIPE SHALL APPLY FROM RIGHT-OF-WAY TO RIGHT-OF-WAY.
- 3) MARKER TO INDICATE LOCATION OF PIPELINE AT RIGHT-OF-WAY LINE. IN ADDITION, MARKERS SHALL BE INSTALLED AT MINIMUM 500 FT. INTERVALS ALONG PIPELINE ENCROACHMENTS AND AT LOCATIONS OF MAJOR CHANGE OF DIRECTION.
- 4) MINIMUM OF 50' FROM THE END OF ANY RAILROAD BRIDGE, ϵ OF ANY CULVERT, OR FROM ANY SWITCHING AREA.
- 5) SIGNAL REPRESENTATIVE MUST BE PRESENT DURING INSTALLATION IF RAILROAD SIGNALS ARE IN THE VICINITY OF CROSSING.
- 6) ALLOWABLE FIXED OBJECTS INCLUDE: BACKWALLS OF BRIDGES; ϵ OF ROAD CROSSINGS & OVERHEAD VIADUCTS (GIVE ROAD NAME), OR CULVERTS.
- 7) CASING AND CARRIER PIPE MUST BE PLACED A MINIMUM OF 2 FEET BELOW THE EXISTING FIBER OPTIC CABLE. ANY EXCAVATION REQUIRED WITHIN 5 FEET OF THE EXISTING FIBER OPTIC CABLE MUST BE HAND DUG.
- 8) CARRIER PIPE MUST BE OF STEEL CONSTRUCTION WITH CATHODIC PROTECTION PROVIDED

A) IS PIPELINE CROSSING WITHIN DEDICATED STREET? YES; NO;

B) IF YES, NAME OF STREET _____

C) CARRIER PIPE :
 COMMODITY TO BE CONVEYED (NO LIQUIDS ALLOWED) _____
 OPERATING PRESSURE _____ PSI
 WALL THICKNESS _____; DIAMETER _____;

D) METHOD OF INSTALLING CARRIER PIPE UNDER TRACK(S):
 DRY BORE AND JACK (WET BORE NOT PERMITTED);
 TUNNEL; OTHER _____

E) DISTANCE FROM CENTER LINE OF TRACK TO NEAR FACE OF BORING AND JACKING PITS WHEN MEASURED AT RIGHT ANGLES TO TRACK _____ (30' MIN.)

F) WILL CONSTRUCTION BE BY AN OUTSIDE CONTRACTOR? YES; NO;

G) APPLICANT HAS CONTACTED 1-800-336-9193, U. P. COMMUNICATIONS DEPARTMENT, AND HAS DETERMINED FIBER OPTIC CABLE DOES; DOES NOT; EXIST IN VICINITY OF WORK TO BE PERFORMED. TICKET NO. _____

EXHIBIT "A"

(FOR RAILROAD USE ONLY - DO NOT WRITE IN THIS BOX)

(SUBDIVISION)

M. P. _____ E. S. _____

UNCASED GAS PIPELINE AT

(NEAREST RR STATION) (COUNTY) (STATE)

FOR _____ (APPLICANT)

RR FILE NO. _____

WARNING

IN ALL OCCASIONS, U. P. COMMUNICATIONS DEPARTMENT MUST BE CONTACTED IN ADVANCE OF ANY WORK TO DETERMINE EXISTENCE AND LOCATION OF FIBER OPTIC CABLE. PHONE : 1-800-336-9193